

## Aerial Wakeboarding Limited Warranty

Limited Warranty. Aerial Wakeboarding ("Aerial") warrants to the original purchaser (the "Customer") that each wake board product manufactured by Aerial (the "Product") will be free from defects in materials and workmanship for a period of one year after the date it is sold to Customer.

Anodized and powder coated surfaces as well as all hardware corrosion are specifically excluded as their care and use cannot be controlled by Aerial Wakeboarding. Any modifications or improper use, not approved in writing by Aerial Wakeboarding, shall void this warranty.

AERIAL MAKES NO OTHER REPRESENTATION OR WARRANTY OF ANY KIND, WHETHER EXPRESSED OR IMPLIED, EITHER IN FACT OR BY OPERATION OF LAW. AERIAL EXPRESSLY DISCLAIMS ALL WARRANTIES OF MERCHANTABILITY, FITNESS FOR A PARTICULAR PURPOSE AND IMPLIED WARRANTIES ARISING FROM COURSE OF DEALING OR COURSE OF PERFORMANCE.

AERIAL MAKES NO REPRESENTATION OR WARRANTY WITHOUT RESPECT TO ANY PRODUCT MANUFACTURED BY PERSONS OTHER THAN AERIAL, INCLUDING WHETHER THOSE PRODUCTS ARE SUITABLE FOR USE WITH THE PRODUCT, AND ANY WARRANTY WITH RESPECT TO THOSE PRODUCTS IS MADE ONLY BY THE MANUFACTURER OF THOSE PRODUCTS.

ALL WARRANTIES, IF ANY, BY THOSE MANUFACTURERS WILL BE LIABLE FOR PERFORMANCE OF THOSE WARRANTIES. WITHOUT IN ANY WAY LIMITING THE PRECEDING, AERIAL MAKES NO WARRANTY WITH RESPECT TO WHETHER THE PRODUCT IS SUITABLE FOR INSTALLATION ON OR USE WITH CUSTOMER'S BOAT.

Exclusive Remedy: Limitation of Damages. Aerial's entire liability for any breach of the limited warranty set forth above (whether in tort, contract or any other theory), and Customer's sole remedy, is for Aerial, at Aerial election, either to cure any defect in the Product or to refund the amounts paid by Customer for the defective Product.

IN NO EVENT WILL AERIAL BE LIABLE FOR ANY INDIRECT, PUNITIVE, EXEMPLARY, SPECIAL, INCIDENTAL OR CONSEQUENTIAL DAMAGES, INCLUDING ANY LOST PROFITS OR REVENUES OR LOSS OF USE OR GOODWILL, EVEN IF CUSTOMER HAS BEEN ADVISED OF THE POSSIBILITY OF SUCH DAMAGES.

Legal Notices. Some states do not allow limitations on how long an implied warranty lasts, so the above limitation may not apply to Customer. Some states do not allow the exclusion or limitation of incidental or consequential damages, so the above limitation or exclusion may not apply to Customer. This Limited Warranty gives Customer specific legal rights and Customer may also have other rights that vary from state to state.

If you need to make a warranty claim contact Aerial Wakeboarding at 888-893-6499 to receive a return authorization number ("RMA") which is required for all claims. Defects must be reported within 30 days of receipt. Any return received by Aerial without an RMA number will be refused and returned to the shipper at their expense.

Returns or Exchanges should be sent to:

Aerial Wakeboarding, 23172 Alcalde Drive, Suite G, Laguna Hills, California 92653

If, for some reason, you received a Product (or Product accessory) that was damaged or had missing parts please call us at 1-888-893-6499 and we will promptly send out replacement parts to get you back on the water quickly at no cost to you. The Aerial Wakeboarding also carries a 1-Year Warranty against defects in parts or workmanship.

For items purchased from a dealer or distributor, please contact them directly and we will work through them to resolve any support issues. Items purchased through a domestic dealer or international distributor cannot be returned directly to Aerial Wakeboarding. Any duties, freight, taxes, customs fees and installation costs are non-refundable.



# Aerial WAKEBOARDING PRODUCTS INSTALLATION GUIDE

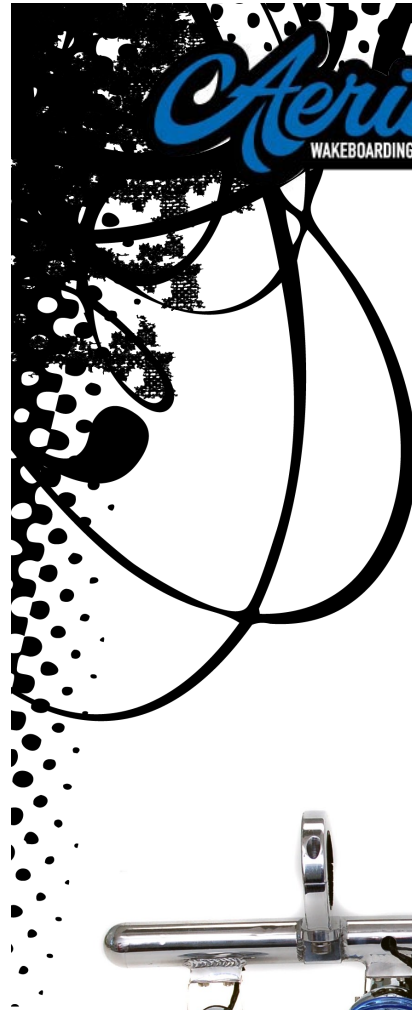

LIGHTBAR		
CLAMP SIZE	FINISH	PART NUMBER
2.25 To 2.5"	Polished Aluminum	BT-5LITE225-PA

# 1

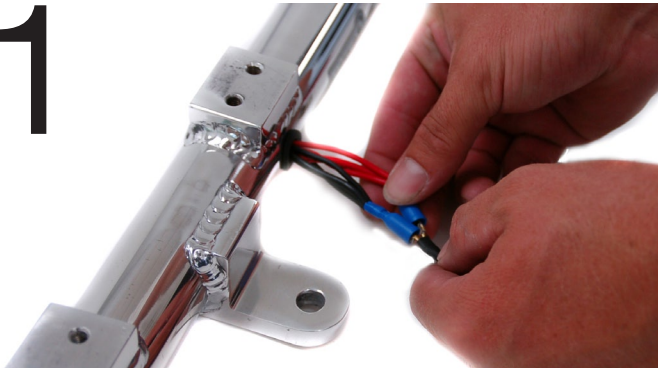

connect wires x5

# 2

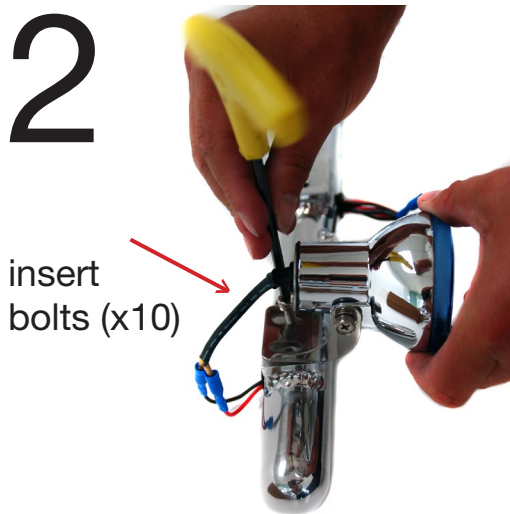

insert bolts (x10)

# 3



tighten bolts (x2)

Notes on installing/wiring your Aerial Light Bar:

Every boat is different and you may need to improvise to accommodate your needs.

This diagram is merely a guideline and a professional marine specialist should be consulted if at anytime you need assistance.

We recommend using an Aerial wiring harness available at [www.aerialwakeboarding.com](http://www.aerialwakeboarding.com).

Your Aerial Light Bar was designed to house your wires (in the cross bar) for a professional and watertight appearance. All exposed wires should be wrapped with electrical tape. We recommend attaching your light bar to one of our Aerial Towers which also houses your light and speaker wires in the legs.

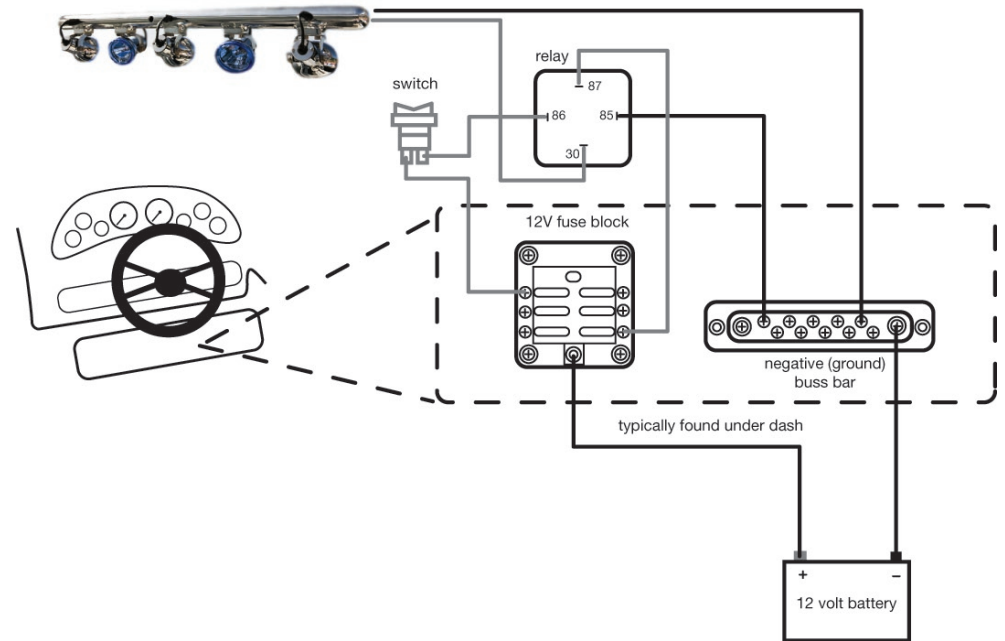

MORE PRODUCTS AVAILABLE FROM AERIAL:

speakers, lightbars, speaker/lightbar combos ,mirrors, racks, towers, covers...

